

ELEVATION

VELUX Skylights installed in new metal roofing
 

- The sheets are fitted 100 mm from the bottom frame
- The flashing is mounted
- Fit the metal sheets
- Skylights must be spaced 100mm apart for EKW centre channel to fit

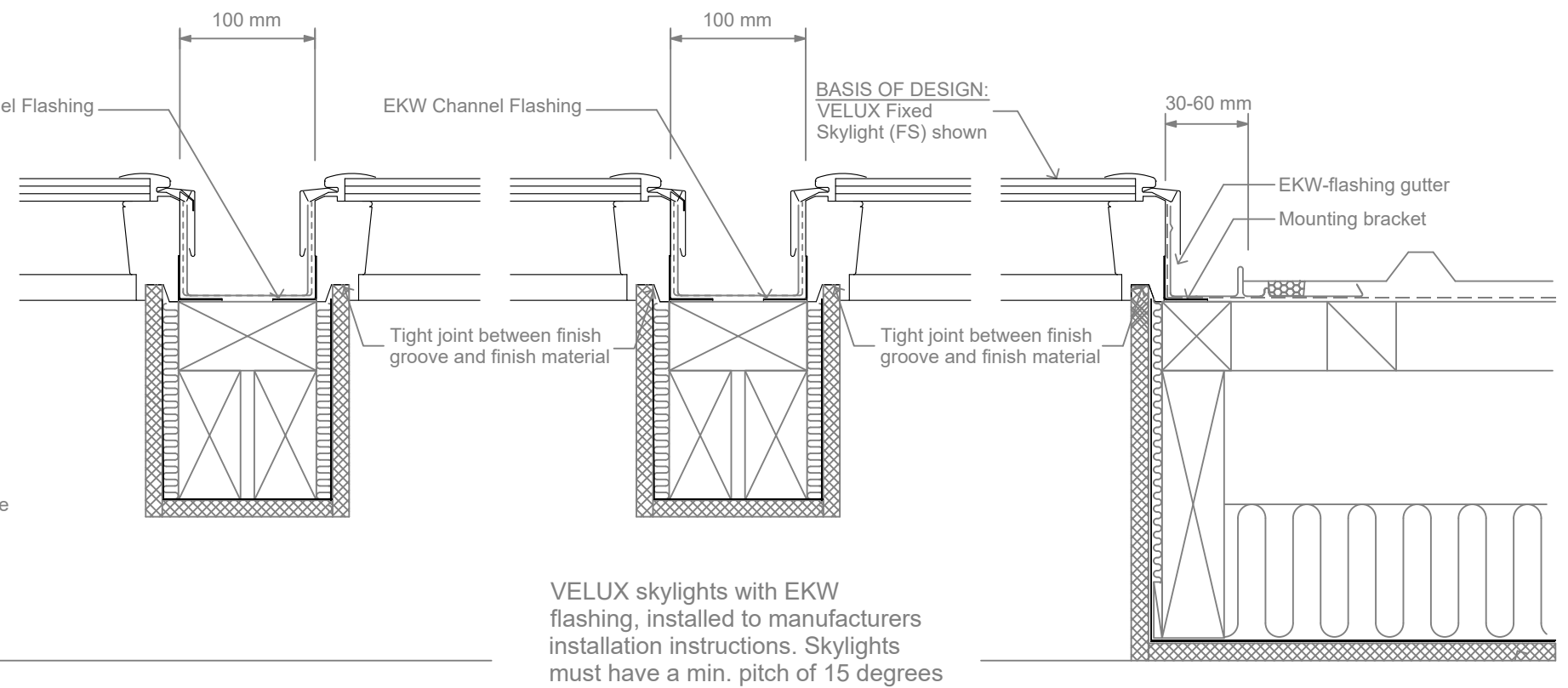

VELUX skylights with EKW flashing, installed to manufacturers installation instructions. Skylights must have a min. pitch of 15 degrees